

长方管

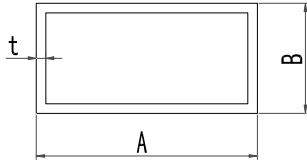

长方管

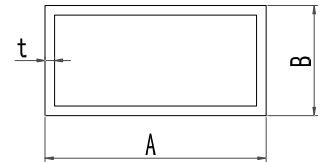

型号	长A	宽B	壁厚t	理重(kg/m)
B0615	15	5.5	0.6	0.061
15X6X0.8	15	6	0.8	0.084
15X8.5	15	8.5	0.7	0.084
19.1X12.7X1.4	19.05	12.7	1.4	0.219
20X14	20	14	0.8	0.14
25X12.5	25	12.5	1	0.192
25X12.5	25	12.5	1.2	0.228
25X15X1.25	25	15	1.25	0.254
25X20	25	20	1.5	0.341
25.4X12.7X1.4	25.4	12.7	1.4	0.268
27X17X1.3	27	17	1.3	0.292
30X15	30	15	1.5	0.341
30X20X1.1	30	20	1.05	0.273
35X25	35	25	1	0.314
38X10	38	10	1	0.249
SE2515	38	19	0.95	0.284
38X25	38	25	0.6	0.201
38X25	38	25	0.7	0.234
38X25	38	25	0.8	0.266
38X25	38	25	0.9	0.299
38X25	38	25	1	0.33
38X25	38	25	1.1	0.362
38X25	38	25	1.2	0.394
38X25	38	25	1.3	0.426
38X25	38	25	1.4	0.457
38X25	38	25	1.5	0.488
38X25	38	25	1.6	0.519
38X25	38	25	2	0.64
ADV02	38	25.3	1.6	0.521
RT1.5X0.625X0.05	38.1	15.87	1.27	0.353
RT1.5X0.625	38.1	15.87	2	0.542
11258050	38.1	15.88	1.27	0.353
38.1X19.1X3.2	38.1	19.1	3.18	0.874
38.1X25.4	38.1	25.4	3.18	0.985
38.1X25.4X3.18A	38.1	25.4	3.18	0.982
39X29	39	29	1	0.353
40X10X1.2	40	10	1.2	0.31
40X20X1.3	40	20	1.3	0.404
40X20	40	20	2	0.607
40X23	40	23	2	0.639

型号	长A	宽B	壁厚t	理重(kg/m)
40*28	40	28	1.2	0.427
44X33	44	33	2.5	0.976
44X33	44	33	3	1.155
44.45X38.1	44.45	38.1	1.78	0.76
45X20	45	20	1	0.341
45X25	45	25	3	1.041
45X38	45	38	1.2	0.524
CB06	48.2	18.2	1	0.349
50X15X1.2	50	15	1.2	0.407
50X20X1.2	50	20	1.2	0.44
50X25	50	25	0.7	0.279
50X25	50	25	0.8	0.318
50X25	50	25	0.9	0.357
50X25	50	25	1	0.396
50X25	50	25	1.2	0.472
50X25	50	25	1.3	0.51
50X25	50	25	1.4	0.548
50X25	50	25	1.5	0.585
50X25	50	25	1.7	0.66
50X25	50	25	2	0.77
50X25	50	25	3	1.122
50X30X1.8	50	30	1.75	0.726
50X30X2	50	30	2	0.824
50X40	50	40	2	0.932
50X40X4	50	40	4	1.778
50X45	50	45	1.2	0.602
SE2521	50.8	25.4	1.117	0.448
SQ-2-1	50.8	25.4	2.4	0.933
50.8X25.4	50.8	25.4	3.175	1.202
50.8X25.4X3.18	50.8	25.4	3.18	1.202
50.8X25.4X3.18A	50.8	25.4	3.18	1.202
5121	51	21	1.2	0.453
33.5X18X2	33.5	18	2	0.515
54.5X34.5	54.5	34.5	2.5	1.138
55X45X2	55	45	2	1.04
60X20X1.3	60	20	1.3	0.545
60X20X1.5	60	20	1.5	0.626
60X40	60	40	1.2	0.635
60X40X1.3	60	40	1.3	0.686
60X40	60	40	1.4	0.738

长方管

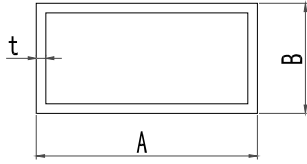

长方管

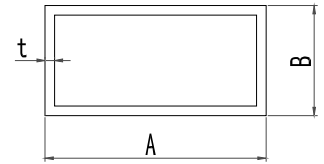

型号	长A	宽B	壁厚t	理重 (kg/m)
60X40	60	40	2	1.041
60X40	60	40	2.5	1.287
60.3X25.4X1	60.3	25.4	1	0.454
YF13	63	25	2.5	1.125
66.7X38.1	66.67	38.1	4.75	2.453
67X25	67	25	0.9	0.44
67X25	67	25	1	0.488
67X25	67	25	1.2	0.583
67X25	67	25	1.3	0.63
67X25	67	25	1.4	0.677
70X15	70	15	1.2	0.537
70X25	70	25	1.2	0.602
70X30	70	30	1.2	0.635
70X30	70	30	2	1.041
70X40	70	40	1.2	0.7
70X40	70	40	2	1.149
70X45	70	45	2	1.203
70X50	70	50	1.2	0.765
70X50	70	50	1.4	0.889
70X50	70	50	2	1.257
72X20X1.2	72	20	1.2	0.583
72X20X1.4	72	20	1.4	0.677
H155259	73.1	37.5	4.5	2.478
76X20	76	20	0.8	0.403
76X20	76	20	0.9	0.453
76X20	76	20	1	0.502
76X25	76	25	0.7	0.378
76X25	76	25	0.8	0.431
76X25	76	25	0.9	0.484
76X25	76	25	1	0.537
76X25	76	25	1.1	0.589
76X25	76	25	1.2	0.641
76X25	76	25	1.3	0.693
76X25	76	25	1.4	0.745
76X25	76	25	1.5	0.797
76X25	76	25	1.6	0.848
76X25	76	25	1.8	0.95
76X44	76	44	0.8	0.513
76X44	76	44	0.9	0.576
76X44	76	44	1	0.639

型号	长A	宽B	壁厚t	理重 (kg/m)
76X44	76	44	1.2	0.765
76X44	76	44	1.3	0.827
76X44	76	44	1.4	0.889
76X44	76	44	1.5	0.951
76X44	76	44	1.6	1.013
76X44	76	44	1.8	1.135
76X44	76	44	2	1.257
76X44	76	44	2.5	1.558
76X44	76	44	3	1.853
76X45X4	76	45	4	2.45
76X45X6	76	45	6	3.545
76.2X25.4X3.18	76.2	25.4	3.18	1.638
76.2X25.4X3.18	76.2	25.4	3.18	1.639
76.2X38.1X1.4	76.2	38.1	1.4	0.858
76.2X38.1X3.18	76.2	38.1	3.18	1.857
SE2522	76.2	44.7	1.26	0.808
JND65	76.2	50.8	1.78	1.189
76.2X50.8A	76.2	50.8	3.175	2.076
76.2X63.5	76.2	63.5	7.94	5.327
78X38	78	38	1	0.618
80X20X1.5	80	20	1.5	0.789
80X25	80	25	0.9	0.503
80X25	80	25	1	0.558
80X25	80	25	1.2	0.667
80X25	80	25	1.4	0.775
80X33	80	33	2.5	1.463
80X40X1.3	80	40	1.3	0.827
80X45	80	45	0.9	0.601
80X45	80	45	1	0.667
80X45	80	45	1.2	0.797
80X60	80	60	2.5	1.829
81X33.5X3	81	33.5	3	1.764
88X25	88	25	0.7	0.423
88X25	88	25	0.8	0.483
88X25	88	25	0.9	0.542
88X25	88	25	1	0.602
88X25	88	25	1.2	0.719
88X25	88	25	1.3	0.778
88X25	88	25	1.4	0.836
88X44X0.8	88	44	0.8	0.565

长方管

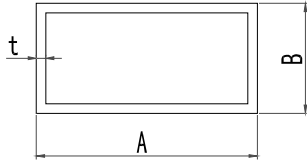

长方管

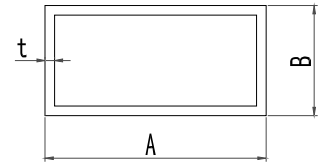

型号	长A	宽B	壁厚t	理重 (kg/m)
88X44	88	44	0.9	0.635
88X44	88	44	1	0.705
88X44	88	44	1.2	0.843
88X44	88	44	1.3	0.912
GL006	89	56	4	2.97
90X25	90	25	0.8	0.492
90X25	90	25	0.9	0.552
90X25	90	25	1	0.612
90X25	90	25	1.2	0.732
90X25	90	25	1.3	0.792
90X35	90	35	0.8	0.535
90X35	90	35	0.9	0.601
90X35	90	35	1	0.667
90X35	90	35	1.2	0.797
90X35	90	35	1.4	0.927
90X35	90	35	1.8	1.184
90X50X2	90	50	2	1.474
93.4X19.2X1.8	93.4	19.2	1.8	1.063
96X25	96	25	0.8	0.518
96X25	96	25	0.9	0.581
96X25	96	25	1	0.645
96X25	96	25	1.1	0.708
96X25	96	25	1.2	0.771
98X38	98	38	1	0.726
99.5X55	99.5	55	3	2.415
100X20X1.1	100	20	1.1	0.702
100X25	100	25	0.9	0.601
100X25	100	25	1	0.667
100X25	100	25	1.1	0.732
100X25	100	25	1.2	0.797
100X25	100	25	1.3	0.862
100X25	100	25	1.4	0.927
100X25	100	25	1.5	0.992
100X25	100	25	1.6	1.056
100X25	100	25	2	1.312
100X25	100	25	3	1.935
100X30	100	30	3	2.016
100X44	100	44	0.9	0.694
100X44	100	44	1	0.77
100X44	100	44	1.1	0.845

型号	长A	宽B	壁厚t	理重 (kg/m)
100X44	100	44	1.2	0.921
100X44	100	44	1.3	0.996
100X44	100	44	1.4	1.071
100X44	100	44	1.5	1.146
100X44	100	44	1.8	1.37
100X44	100	44	2	1.518
100X44	100	44	2.5	1.883
100X44	100	44	3	2.244
100X44	100	44	3.5	2.599
100X50X2	100	50	2	1.583
100X50X2.5	100	50	2.5	1.965
100X65	100	65	1.2	1.058
100X70	100	70	1.8	1.623
100X70X2.2	100	70	2.2	1.975
SE2520	101	44	1.36	1.049
102X25	101.6	25.4	0.9	0.611
102X25	101.6	25.4	1	0.678
102X25	101.6	25.4	1.1	0.744
102X25	101.6	25.4	1.2	0.81
102X25	101.6	25.4	1.3	0.877
101.6X44.45	101.6	44.45	1.57	1.22
101.6X44.4X1.7	101.6	44.4	1.725	1.335
101.6X44.4X3.2	101.6	44.4	3.18	2.404
102X44.5	101.6	44.5	1.2	0.935
102X44.5	101.6	44.5	1.3	1.011
102X44.5	101.6	44.5	1.5	1.163
101.5X50.8	101.6	50.8	3.05	2.418
JND426	101.6	50.8	3.18	2.494
102X45	102	45	1.2	0.94
105X47	105	47	3	2.374
150X50X1.2	150	50	1.2	1.285
110X50	110	50	1.4	1.193
110X60	110	60	1.5	1.357
110X60	110	60	2	1.799
110X65	110	65	2.5	2.304
112X47	112	47	3.5	2.883
120X25X1.4	120	25	1.4	1.079
120X40	120	40	3	2.504
H155202	120	47	3	2.618
120*80	120	80	2	2.125

长方管

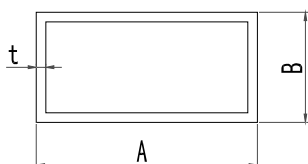

正方管

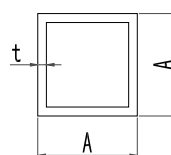

型号	长A	宽B	壁厚t	理重(kg/m)
120X110	120	110	1.4	1.724
127X30X3	127	30	3	2.455
130X55X1.2	130	55	1.2	1.188
H17022	135	47	3	2.862
140X25	140	25	1	0.883
140X25	140	25	1.2	1.058
140X35	140	35	0.9	0.845
140X35	140	35	1.2	1.123
140X50X1.5	140	50	1.5	1.52
140X50X2	140	50	2	2.016
140X50X3.0	140	50	3	2.992
140X80X3	140	80	3	3.48
5490	152.4	50.8	3.175	3.387
H1812	153.8	59.1	4	4.442
200X90	200	90	3	4.618
200*100	200	100	3	4.78
200X110X3.5	200	110	3.5	5.748
215X120X3	215	120	3	5.35
220X100X2.8	220	100	2.8	4.771

正方管

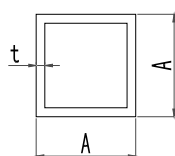

型号	长A	壁厚t	理重(kg/m)
13X13	13	1	0.13
13X13	13	1.2	0.153
SB-3373	15.88	1.25	0.198
16X16	16	0.8	0.132
16X16	16	1	0.163
16X16	16	2	0.304
18X18X1.2	18	1.2	0.219
19.1X19.1X1.3	19.1	1.27	0.245
SB-4065	19.05	1.6	0.303
19.1X19.1X3.2	19.05	3.18	0.546
20X20	20	0.8	0.167
20X20	20	0.9	0.186
20X20	20	1	0.206

型号	长A	壁厚t	理重(kg/m)
20X20	20	1.2	0.245
20X20	20	1.7	0.337
20X20	20	2	0.39
25X25	25	0.6	0.159
25X25	25	0.7	0.184
25X25	25	0.8	0.21
25X25	25	0.9	0.235
25X25	25	1	0.26
25X25	25	1.1	0.285
25X25	25	1.2	0.31
25X25	25	1.4	0.358
25X25	25	1.5	0.382
25X25	25	1.8	0.453
25X25	25	2	0.499
25X25	25	2.2	0.544
25X25	25	2.5	0.61
25X25	25	3	0.715
SE2362	25.4	0.905	0.24
25.4X25.4	25.4	0.9	0.239
25.4X25.4X1.5	25.4	1.52	0.394
912	25.4	1.58	0.408
25.4X25.4X1.7	25.4	1.65	0.425
25.4X25.4X2.29	25.4	2.29	0.574
WS-1470	25.4	3.05	0.739
25.4X25.4	25.4	3.18	0.765
30X30X2	30	2	0.607
30X30X3	30	3	0.878
SE2354	31.6	1.1	0.364
31.8X31.8X3.2	31.75	3.18	0.983
38X38	38	1	0.401
38X38	38	1.2	0.479
38X38	38	1.4	0.555
38X38	38	1.5	0.593
38X38	38	2	0.78
ST115	38	2	0.78
38X38	38	2.5	0.962
38X38	38	3	1.138
38.1X38.1X1.02	38.1	1.02	0.408
SB-3789	38.1	1.9	0.745
SB-3789	38.1	4.47	1.629

正方管

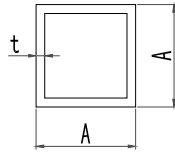

正方管

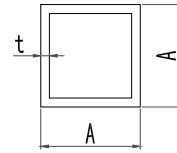

型号	长A	壁厚t	理重(kg/m)
SB-4005	38.1	2.4	0.932
V864462	38.1	3.05	1.159
38.1X38.1X3.18	38.1	3.18	1.202
40X40	40	1	0.423
40X40	40	1.2	0.504
40X40X1.3	40	1.3	0.545
40X40	40	1.5	0.626
40X40	40	2	0.824
40X40	40	2.5	1.016
40X40	40.2	0.65	0.277
44X44	44	2	0.911
SE2364	44.4	1.105	0.519
44.5X44.5X1.5	44.5	1.52	0.709
44.5X44.5X1.6	44.45	1.6	0.743
44.45X44.45	44.45	2.29	1.045
50X50	50	1	0.531
50X50	50	1.2	0.635
50X50	50	1.4	0.738
50X50	50	1.6	0.839
50X50	50	2	1.041
50X50	50	2.5	1.287
50X50	50	3	1.528
50.8X50.8X1.1	50.8	1.14	0.614
50.8X50.8X1.6	50.8	1.6	0.853
SB-4075	50.8	2.4	1.259
SB-4066	50.8	3.18	1.642
50.8X50.8B	50.8	4.775	2.382
50.8X50.8A	50.8	6.35	3.06
55X55X2.5	55	2.5	1.423
60X60	60	1.5	0.951
60X60X5	60	5	2.979
60X60X6	60	6	3.51
65X65	65	2.5	1.694
69.85X69.85	69.85	2	1.471
76X76	76	1	0.813
76X76	76	1.2	0.973
76X76	76	1.4	1.132
76X76	76	2	1.604
76X76	76	3	2.374
76.2X76.2X2.4	76.2	2.36	1.89

型号	长A	壁厚t	理重(kg/m)
SB-4067	76.2	3.18	2.517
JND26	76.2	3.81	2.989
JND200	76.2	4.78	3.697
80X80	80	1	0.856
80X80	80	1.2	1.024
88X88	88	1	0.943
88X88	88	1.1	1.036
88X88	88	1.2	1.129
88X88X3	88	3	2.764
100X100	100	1	1.073
100X100	100	1.2	1.285
100X100	100	1.4	1.496
100X100	100	1.5	1.602
100X100	100	1.6	1.707
100X100	100	2	2.125
100X100	100	2.5	2.642
100X100	100	4	4.163
101.6X101.6	101.6	1.78	1.924
101.6X101.6X3.2	101.6	3.18	3.388
101.6X101.6X6.4	101.6	6.35	6.556
130X130	130	4.5	6.122

槽

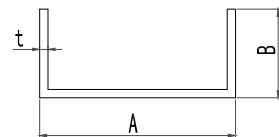

型号	长A	高B	壁厚t	理重(kg/m)
C6X12	6	12	0.6	0.047
C6X12	6	12	0.8	0.062
C8X8	8	8	0.7	0.043
C8X8	8	8	0.8	0.049
C8X8	8	8	1	0.06
C8X8X1	8	8	1	0.06
C8X13X1	8	13	1	0.087
C8X23X1	8	23	1	0.141
C8X26X1.2	8	26	1.2	0.19
C8.7X8.7X0.8	8.7	8.7	0.8	0.051
C9X12	9	12	1	0.084

槽

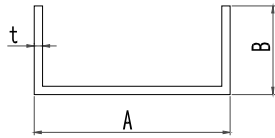

槽

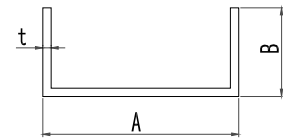

型号	长A	高B	壁厚t	理重 (kg/m)
C9X9	9.5	9.5	0.7	0.051
C9X9	9.5	9.5	0.8	0.058
C10X10	10	10	0.7	0.054
C10X10	10	10	0.8	0.062
C10X10	10	10	0.9	0.069
C10X10	10	10	1	0.076
C10X10	10	10	1.2	0.09
C10X16X1	10	16	1	0.108
JND70	11.11	12.7	2.36	0.204
C12X12	12	12	0.7	0.066
C12X12	12	12	0.8	0.075
C12X12	12	12	0.9	0.083
C12X12	12	12	1	0.092
C12X12	12	12	1.2	0.109
C12X14	12	14	1.2	0.116
C12.6X12.6	12.6	12.6	0.98	0.095
C12.7X12.7	12.7	12.7	1.14	0.111
C15X10	15	10	1	0.089
C15X15	15	15	0.7	0.083
C15X15	15	15	0.8	0.094
C15X15	15	15	0.9	0.105
C15X15	15	15	1	0.117
C15X15	15	15	1.2	0.139
DM11	15.88	3.96	1.32	0.075
JHW01	16	13	1.5	0.158
C18X18	18	18	0.8	0.114
C18X18	18	18	0.9	0.127
C18X18	18	18	1	0.141
C18X18	18	18	1.2	0.168
C18X18	18	18	1.8	0.246
C18X18	18	18	1.9	0.258
JUR52	18	19	1.5	0.215
C18X24	18	24	1.8	0.304
C18.5X12X1.2	18.5	12	1.2	0.13
H11007	19	26	1.8	0.329
H11007B	19	26	3	0.528
C20X5	20	5	0.9	0.069
C20X7	20	7	0.8	0.07
C20X7	20	7	0.9	0.079
C20X7	20	7	1	0.087

型号	长A	高B	壁厚t	理重 (kg/m)
C20X20	20	20	3	0.439
C20X25	20	25	2.5	0.44
C20X40	20	40	2.5	0.643
C22X12.5	22	12.5	1	0.121
C22.23X22.23X3.18	22.23	22.23	3.18	0.52
FE123-5	25	6	3	0.252
C25X15	25	15	1	0.144
C25X20	25	20	1	0.171
C25X20	25	20	1.2	0.204
C25X20X1.5	25	20	1.5	0.252
C25X20	25	20	2	0.331
C25X20	25	20	2.5	0.407
C28X19.5X1.5	28	19.5	1.5	0.26
WX04	28	30	2	0.455
C30X12X1.0	30	12	1	0.14
H2111	30	27	2	0.434
C33.1	33.1	13.5	1.2	0.188
C35X15	35	15	1.2	0.204
C35X15	35	15	1.4	0.236
C35X21X1.5	35	21	1.5	0.301
FL423-103	37.8	3	1.2	0.135
C38X13	38	13	1	0.168
C38X13	38	13	1.2	0.2
C38x65x6	38	65	6	2.54
C38.1X19.05	38.1	19.05	1.6	0.316
SB-3960	38.1	19.05	1.8	0.354
C38.1X19.05X1.91	38.1	19.05	1.905	0.374
SB-3998	38.1	19.05	2.03	0.395
C38.1X25.4X3.2	38.1	25.4	3.175	0.71
C40X40	40	40	3	0.927
C42X25.5X2	42	25.5	2	0.482
JND219	44.45	19.05	2.29	0.483
DFW08	46	50	15	4.715
C50X10	50	10	1	0.184
C50X12	50	12	0.9	0.176
C50X13	50	13	1	0.201
C50X13	50	13	1.2	0.239
SNH02	50	25	3	0.764
C50X50X3	50	50	3	1.171
C50.8X11.1X0.9	50.8	11.1	0.86	0.167

槽

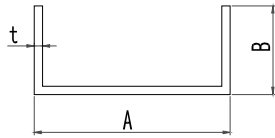

槽

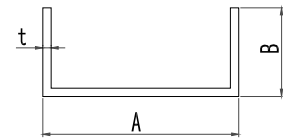

型号	长A	高B	壁厚t	理重 (kg/m)
C50.8X25.4X3.1	50.8	25.4	3.05	0.789
C50.8X25.4X3.2	50.8	25.4	3.175	0.82
C53.1X26.5X1.1	53.09	26.54	1.14	0.322
C54X20X1.5	54	20	1.5	0.37
C55X30	55	30	2	0.602
C60X12X2.5	60	12	2.5	0.535
C60.3X22X1	60.3	22	1	0.277
C61.3X60X4.8	61.3	60	4.76	2.216
C63.4X25.4X2	63.4	25.4	2	0.605
C75.5X15X1.1	75.5	15	1.1	0.307
C76X13	76	13	0.9	0.244
C76X13	76	13	1	0.271
C76X13	76	13	1.1	0.298
C76X13	76	13	1.2	0.324
C76X25	76	25	0.9	0.303
C76X25	76	25	1.2	0.402
C76.2X25.4	76.2	25.4	3.175	1.038
3271	76.2	50.8	3.18	1.477
C78.7X31.75X1.57	78.7	31.75	1.57	0.593
C80X13	80	13	0.7	0.198
C80X13	80	13	0.8	0.226
C80X13	80	13	0.9	0.254
C80X13	80	13	1	0.282
C80X13	80	13	1.2	0.337
C80X13.5X1	80	13.5	1	0.284
C80X15	80	15	0.9	0.263
C80X20X0.8	80	20	0.8	0.256
C80X20X1.0	80	20	1	0.319
C80.6X34.9X1.6	80.6	34.93	1.57	0.629
C82X16	82	16	1.2	0.363
C83X12	83	12	1	0.285
C88X23	88	23	1	0.358
C88.9X17.5X1.6	88.9	17.46	1.59	0.519
C90X12	90	12	1	0.304
C90X12	90	12	1.2	0.363
C90X13	90	13	0.8	0.248
C90X13	90	13	0.9	0.279
C90X13	90	13	1	0.309
C90X13	90	13	1.1	0.339
C90X13	90	13	1.2	0.369

型号	长A	高B	壁厚t	理重 (kg/m)
C90X25	90	25	0.9	0.337
C90X25	90	25	1	0.374
C90X25	90	25	1.1	0.411
C90X25	90	25	1.2	0.477
C95X13	95	13	0.9	0.291
C95X13	95	13	1	0.322
C95X13	95	13	1.2	0.386
C100X13	100	13	1	0.336
C100X13	100	13	1.1	0.369
C100X13	100	13	1.2	0.402
C100X13	100	13	1.3	0.435
C100X25	100	25	0.9	0.361
C100X25	100	25	1	0.401
C100X25	100	25	1.2	0.48
C100X38	100	38	1.5	0.703
C104X45X1.2	104	45	1.2	0.623
FL30-8	146	22	3	1.495
FE117-21	154	30	2	1.14
C155X77.5X1.8	155	77.5	1.8	1.495
C199X13	199	13	1.5	0.902
SDR01	200	110	2.5	2.812
JGL01	224	22.8	2	1.438

角

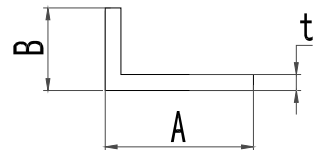

型号	长A	宽B	壁厚t	理重 (kg/m)
J8X8X1	8	8	1	0.041
J8X8	8	8	2.5	0.091
J9.5X9.5X1.6	9.53	9.53	1.59	0.075
J10X10	10	10	0.7	0.037
J10X10	10	10	0.8	0.042
J10X10	10	10	1	0.051
J10X10	10	10	2.1	0.102
J10X10	10	10	2.7	0.127
J12X8	12	8	1	0.051
J12X12	12	12	0.7	0.044

角

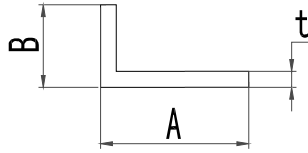

角

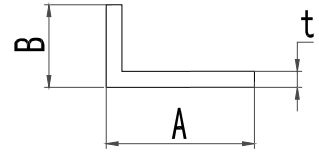

型号	长A	宽B	壁厚t	理重(kg/m)
J12X12	12	12	0.8	0.05
J12X12	12	12	1	0.062
J12X12	12	12	1.2	0.074
J12.4X12.4X0.9	12.4	12.4	0.9	0.058
J12.7X12.7X1	12.7	12.7	1	0.066
J12.7X12.7X3.2	12.7	12.7	3.18	0.191
J13X13	13	13	1	0.068
J15X10	15	10	4	0.228
J15X15	15	15	0.8	0.063
J15X15	15	15	0.9	0.071
J15X15	15	15	1	0.079
J15X15	15	15	1.2	0.094
J15X15	15	15	2	0.152
J15.9X15.9X1.6	15.88	15.88	1.59	0.13
J16X16X2	16	16	2	0.163
J16X10	16	10	1	0.068
J16X10	16	10	1.2	0.081
FU1055-45	17	17	1.8	0.155
J17X17X1	17	17	1	0.089
SE1303	19	19	0.9	0.09
J19.1X19.1X1.6	19.05	19.05	1.6	0.158
J20X16	20	16	2	0.184
J20X20	20	20	0.7	0.075
J20X20	20	20	0.8	0.085
J20X20	20	20	1	0.106
J20X20	20	20	1.2	0.126
J20X20	20	20	1.5	0.157
J20X20	20	20	1.6	0.167
J20X20	20	20	2	0.206
J20X20	20	20	2.5	0.254
J20X20	20	20	3	0.301
J20X30	20	30	2.2	0.285
FU688-45	20.4	20.4	1.8	0.188
J25X12	25	12	1.5	0.144
J25X12	25	12	2	0.19
J25X19	25	19	1.2	0.139
J25X19	25	19	2	0.228
J25X19	25	19	3	0.333
J25X20	25	20	1.5	0.177
J25X20	25	20	2	0.233

型号	长A	宽B	壁厚t	理重(kg/m)
J25X25	25	25	0.7	0.094
J25X25	25	25	0.8	0.107
J25X25	25	25	0.9	0.12
J25X25	25	25	1	0.133
J25X25	25	25	1.2	0.159
J25X25	25	25	1.3	0.172
J25X25	25	25	1.5	0.197
J25X25	25	25	2	0.26
J25X25	25	25	2.5	0.322
J25X25	25	25	3	0.382
SE1304	25.1	25.1	0.83	0.111
J25.4X25.4X1.58	25.4	25.4	1.58	0.211
J25.4X25.4X3.2	25.4	25.4	3.175	0.41
J27X20X2.7	27	20	2.7	0.324
J30X15	30	15	2	0.233
J30X15	30	15	3	0.341
J30X20	30	20	2	0.26
J30X20	30	20	2.5	0.322
J30X20	30	20	3	0.382
J30X20	30	20	5	0.61
J30X30	30	30	1.2	0.191
J30X30	30	30	1.3	0.207
J30X30	30	30	2	0.314
J30X30	30	30	3	0.463
J30X30	30	30	4	0.607
J31.8X31.8X3.2	31.75	31.75	3.175	0.519
J31.8X25.4X2.5	31.8	25.4	2.54	0.376
J31.8X31.8	31.8	31.8	4.775	0.76
H15113	33	23	2	0.293
J35X19	35	19	2	0.282
J35X19	35	19	3	0.415
J35X22	35	22	3	0.439
J38X23	38	23	3	0.472
J38X23	38	23	4	0.618
J38X38X1.5	38	38	1.5	0.303
J38X38	38	38	2	0.401
J38X38	38	38	3	0.593
J38X38	38	38	3.5	0.688
J38X38	38	38	4	0.78
SE1311	38	38	3.87	0.756

角

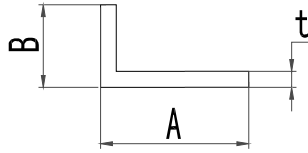

角

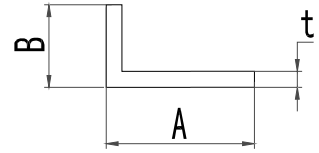

型号	长A	宽B	壁厚t	理重(kg/m)
J38.1X19.1X3.2	38.1	19.05	3.2	0.466
J38.1X25.4	38.1	25.4	1.59	0.266
J38.1X25.4X2.29	38.1	25.4	2.29	0.379
J38X38X1.6	38.1	38.1	1.6	0.323
J38.1X38.1X3.18	38.1	38.1	3.18	0.629
J38.1X38.1	38.1	38.1	4.78	0.924
J39.7X19.05X1.57	39.7	19.05	1.57	0.244
J40X20	40	20	1.5	0.238
J40X20	40	20	1.5	0.238
J40X20X2	40	20	2	0.314
J40X20	40	20	4	0.607
J40X25	40	25	3	0.504
J40X28	40	28	4	0.694
J40X40	40	40	1.5	0.319
J40X40	40	40	1.5	0.319
J40X40	40	40	1.6	0.34
J40X40X2.5	40	40	2.5	0.525
J40X40	40	40	3	0.626
J40X40	40	40	4	0.824
J45X45	45	45	4	0.932
J47X27	47	27	3	0.577
J50X28X3	50	28	3	0.61
J50X25	50	25	3	0.585
J50X50X2	50	50	2	0.531
J50X50	50	50	2.8	0.738
J50X50	50	50	3	0.789
J50X50	50	50	3.2	0.839
J50X50	50	50	4.5	1.165
J50X50	50	50	5	1.287
J50.8X25.4X1.6	50.8	25.4	1.57	0.318
J50.8X25.4X1.9	50.8	25.4	1.905	0.384
J50.8X25.4X3.2	50.8	25.4	3.2	0.633
J50.8X50.8X1.6	50.8	50.8	1.6	0.434
J50.8X50.8X2.4	50.8	50.8	2.36	0.635
J50.8X50.8X3	50.8	50.8	3.05	0.814
BUCH44	50.8	50.8	3.175	0.847
J50.8X50.8X4.7	50.8	50.8	4.67	1.228
J50.8X50.8X6.35	50.8	50.8	6.35	1.639
J51.4X26X1.9	51.44	25.98	1.91	0.39
J60X24	60	24	3.5	0.764

型号	长A	宽B	壁厚t	理重(kg/m)
J60X32X3	60	32	3	0.724
J60X40X3	60	40	3	0.789
EGA02	60	40	2	0.531
J63.5X63.5X3.2	63.5	63.5	3.175	1.065
J76.2X25.4X1.8	76.2	25.4	1.8	0.481
J76.2X25.4	76.2	25.4	3.18	0.847
J76.2X50.8	76.2	50.8	3.18	1.065
J76.2X50.8X3.18	76.2	50.8	3.18	1.065
86X45	86	45	1.2	0.836
J90X80X3	90	80	3	1.358
J127X50.8X3.175	127	50.8	3.175	1.503

扁条

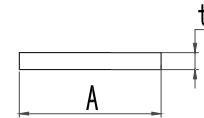

型号	长A	厚t	理重(kg/m)
B6.5X6.5A	6.5	6.5	0.114
B11.7X3	11.7	3	0.095
SM08	11.89	2.64	0.085
B12	12	3	0.098
B12X3	12	3	0.098
B12.7X3.1	12.7	3.1	0.107
B15.2X2.1	15.2	2.1	0.086
B15.88X3.18	15.88	3.18	0.136
B16X3	16	3	0.13
B18	18	3	0.146
B18X3	18	3	0.146
SE1201	18.9	1.45	0.074
B19.1X3.2	19.05	3.18	0.164
B19.05X4.75	19.05	4.75	0.245
B19.05X6.35	19.05	6.35	0.328
B19X19	19.05	19.05	0.984
B19.6X2.6	19.6	2.6	0.138
FL31-9	19.75	1.6	0.084
B20X3	20	3	0.163
B20X4	20	4	0.217
B20	20	4	0.217

扁条

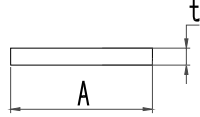

扁条

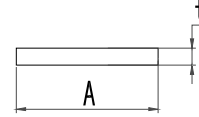

型号	长A	厚t	理重(kg/m)
B20X18	20	18	0.976
B21X2	21	2	0.114
B23X1.8	23	1.8	0.112
B24X5	24	5	0.325
B24.8X6	24.8	6	0.403
B25X3	25	3	0.203
B25X4	25	4	0.271
B25X5	25	5	0.339
B25X13	25	13	0.881
B25.2X1.35	25.2	1.35	0.092
B25.3X3.1	25.3	3.1	0.212
B25.4X2.4	25.4	2.36	0.162
B25.4X3.18	25.4	3.18	0.22
B25.4X4.76	25.4	4.76	0.328
B25.4X6.35	25.4	6.35	0.437
B25.4X9.5	25.4	9.53	0.656
B25.4X12.7	25.4	12.7	0.874
B25.4X19.05	25.4	19.05	1.311
B25.4X25.4	25.4	25.4	1.748
H15115	26	2	0.141
B29X2	29	2	0.157
B30X5	30	5	0.407
B30X10	30	10	0.813
B31.75X6.35	31.75	6.35	0.546
B31.75X9.5	31.75	9.5	0.82
B31.8X12.7	31.75	12.7	1.093
B31.75X19	31.75	19.05	1.64
B31.75X25.4	31.75	25.4	2.185
B32	32	3	0.26
B32X7	32	7	0.607
B35X19	35	19	1.802
B37X1.5	37	1.5	0.15
B38.1X3.2	38.1	3.2	0.33
B38.1X4.7	38.1	4.7	0.485
865	38.1	4.775	0.493
B38.1X6.35	38.1	6.35	0.656
B38.1X9.5	38.1	9.53	0.983
B38.1X12.7	38.1	12.7	1.311
B38.1X19.05	38.1	19.05	1.967
B38.1X25.4	38.1	25.4	2.623

型号	长A	厚t	理重(kg/m)
B38.1X38.1	38.1	38.1	3.934
B40X1.2	40	1.2	0.13
B40X2	40	2	0.217
B40X4	40	4	0.434
B40X6	40	6	0.65
B44X2.5	44	2.5	0.298
AW05	44	7	0.835
B44X12	44	12	1.431
B44.5X6.35	44.5	6.35	0.766
B44.45X25.4	44.45	25.4	3.06
B44.45X44.45	44.45	44.45	5.354
B45X6.5	45	6.5	0.793
B45X13.4	45	13.4	1.634
B45X16.4	45	16.4	2
B45X17.4	45	17.4	2.122
B45X19.4	45	19.4	2.366
B50X6	50	6	0.813
B50X8.1	50	8.1	1.098
B50X10	50	10	1.355
B50.8X3.18	50.8	3.18	0.437
SE1216	50.8	4.5	0.619
B50.8X4.76	50.8	4.76	0.656
B50.8X6.35	50.8	6.35	0.874
B50.8X9.5	50.8	9.525	1.31
B50.8X12.7	50.8	12.7	1.748
B50.8X19.05	50.8	19.05	2.623
B50.8X25.4	50.8	25.4	3.5
B50.8X31.75	50.8	31.75	4.371
B50.8X38.1	50.8	38.1	5.245
B50.8X44.45	50.8	44.45	6.119
B50.8X50.8	50.8	50.8	6.994
B57.15X6.35	57.15	6.35	0.983
B57.15X57.15	57.15	57.15	8.851
B60X3	60	3	0.488
B60X4.85	60	4.85	0.789
B63.5X4.6	63.5	4.6	0.792
B63.5X6.35	63.5	6.35	1.093
B63.5X9.53	63.5	9.53	1.639
B63.5X12.7	63.5	12.7	2.185
B63.5X19.05	63.5	19.05	3.278

扁条

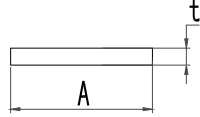

扁条

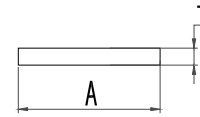

型号	长A	厚t	理重(kg/m)
B63.5X25.4	63.5	25.4	4.37
B63.5X31.75	63.5	31.75	5.464
B63.5X38.1	63.5	38.1	6.556
B63.5X63.5	63.5	63.5	10.927
B65X1.5	65	1.5	0.265
SE2134	72.8	2	0.395
ZYJ04	75	7.5	4.31
B76.2X4.78	76.2	4.78	0.986
B76.2X6.35	76.2	6.35	1.311
B76.2X9.53	76.2	9.53	1.967
B76.2X12.7	76.2	12.7	2.623
B76.2X19.05	76.2	19.05	3.934
B76.2X25.4	76.2	25.4	5.245
B76.2X31.75	76.2	31.75	6.556
B76.2X50.8	76.2	50.8	10.49
B76.2X63.5	76.2	63.5	13.113
B76.2X76.2	76.2	76.2	15.735
B80X10	80	10	2.168
B90X2.5	90	2.5	0.61
B90X5	90	5	1.22
B100X8	100	8.1	2.195
B101.6X3.2	101.6	3.18	0.874
17786	101.6	4.78	1.315
B101.6X6.35	101.6	6.35	1.748
B101.6X9.53	101.6	9.53	2.623
B101.6X12.7	101.6	12.7	3.497
B101.6X19	101.6	19.05	5.25
B101.6X25.4	101.6	25.4	6.994
B101.6X31.75	101.6	31.75	8.742
B101.6X38.1	101.6	38.1	10.49
B101.6X50.8	101.6	50.8	13.987
B114.3X44.45	114.3	44.45	13.77
B127X6.35	127	6.35	2.185
B127X9.53	127	9.525	3.28
B127X12.7	127	12.7	4.371
B144X2.5	144	2.5	0.972
B146.1X4.8	146.1	4.8	1.89
B150X5	150	5	2.032
B150X22	150	22	8.943
B150X30	150	30	12.195

型号	长A	厚t	理重(kg/m)
B152.4X3.2	152.4	3.18	1.311
B152.4X6.35	152.4	6.35	2.623
S-386FL	152.4	9.525	3.934
B152.4X12.7	152.4	12.7	5.245
B152.4X19.05	152.4	19.05	7.868
B152.4X25.4	152.4	25.4	10.49
B165.1X6.4	165.1	6.35	2.841
B167X12.7	167.6	12.7	5.748
B184X12.7	184	12.7	6.34
B184.2x9.5	184.2	9.53	4.753
B200X18	200	18	9.756
B203.2X6.4	203.2	6.35	3.497
B203.2X9.5	203.2	9.53	5.248
B203.2X12.7	203.2	12.7	6.994
MUL02	203.2	27.05	14.9
AYC02	240	6	3.902
B240X6	240	6	3.902
B250X12	250	12	8.13
B250X20	250	20	13.55
B252X5	252	5	3.415
B254X6.4	254	6.35	4.371
B254X12.7	254	12.7	8.742
B254X19.05	254	19.05	13.113
B260.4X9.5	260.4	9.53	6.72
B304.8X6.4	304.8	6.35	5.245
B304.8X9.5	304.8	9.53	7.872
B304.8X12.7	304.8	12.7	10.49
MUL03	304.8	18	14.87
B304.8X19.05	304.8	19.05	15.74
YGC28	304.8	27.15	22.426
B310X4	310	4	3.36
MUL04	315	27.25	23.26
MUL05	330.2	27.25	24.38
B349X20	349	20	18.916
MUL27	355.6	27.25	26.26

圆管

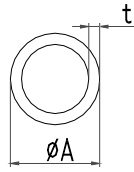

圆管

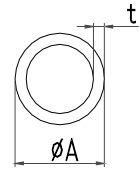

型号	外径A	壁厚t	理重(kg/m)
Y10	10	1.30	0.096
AAS10	11	1.00	0.085
ZJY06	12	2.00	0.17
SWT18	12.7	0.90	0.09
Y13	13	1.40	0.138
Y13	13	1.50	0.147
Y13	13	1.60	0.155
Y13	13	2.00	0.187
Y13.7	13.72	2.24	0.218
Y13.8X0.8	13.8	0.80	0.089
GY007	14	2.00	0.204
Y14.5X2.1	14.5	2.10	0.222
Y16	16	0.90	0.116
Y16	16	1.10	0.14
Y16	16	1.50	0.185
Y16	16	2.00	0.238
Y16X2A	16	2.00	0.238
Y18	18	0.80	0.117
GNT01	18	1.00	0.145
YGC26	19.05	1.65	0.244
Y19.1	19.1	0.80	0.125
Y19.1	19.1	0.90	0.139
Y19.1	19.1	1.00	0.154
Y19.1	19.1	1.20	0.183
Y19.1	19.1	2.00	0.291
FLS01	20	1.00	0.164
Y20X2.0	20	2.00	0.307
Y20X2.0A	20	2.00	0.307
HZY17	20	3.00	0.434
Y20X4.9	20	4.90	0.63
Y21X2.3	21	2.25	0.36
Y21.3	21.34	2.77	0.438
Y22X0.8	22	0.80	0.144
GY005	22	0.90	0.162
Y22	22	1.00	0.179
Y22X2	22	2.00	0.341
Y22.05X1.8	22.05	1.80	0.31
YGC27	22.22	1.65	0.289
YGC30	22.22	2.11	0.361
JND18	22.23	6.35	0.858

型号	外径A	壁厚t	理重(kg/m)
Y23.5X0.9	23.5	0.90	0.173
Y24X1.1	24	1.05	0.205
Y24X1.5	24	1.50	0.287
Y24X5.9	24	5.90	0.909
Y24X6.3	24	6.30	0.95
Y24.6X6.2	24.6	6.20	0.971
Y24.6X6.5	24.6	6.50	1.002
Y25	25	1.00	0.204
Y25X1.5	25	1.50	0.3
Y25X2.0	25	2.00	0.392
Y25	25	2.20	0.427
Y25X6.4	25	6.40	1.013
Y25.2X1.7	25.2	1.70	0.34
Y25.4X1	25.4	1.00	0.208
Y25.4X1.5	25.4	1.50	0.305
Y25.4	25.4	2.00	0.398
YGC29	25.4	2.11	0.418
Y25.4X3.2	25.4	3.20	0.601
YGC25	25.4	3.18	0.602
HZY16	26	6.50	1.079
Y26X6.25	26	6.25	1.051
96	26.67	2.87	0.582
Y27X3.2	26.99	3.18	0.644
Y28X2	28	2.00	0.443
Y28.6X1.5	28.58	1.48	0.34
Y29X8.8	29	8.80	1.513
Y29.5	29.5	0.80	0.195
GNT02	29.8	1.00	0.245
Y30	30	0.80	0.199
Y30	30	0.90	0.223
Y30	30	1.00	0.247
Y30	30	1.20	0.294
Y30X1.5	30	1.50	0.364
Y30X2.3	30	2.30	0.542
Y31.8X3.2	31.8	3.18	0.772
Y32	32	0.90	0.238
Y32	32	1.00	0.264
Y32	32	1.20	0.315
Y32X2.0	32	2.00	0.511
Y32X3	32	3.00	0.741

圆管

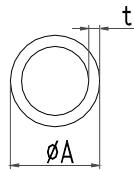

圆管

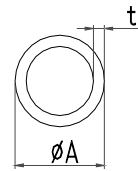

型号	外径A	壁厚t	理重(kg/m)
Y32X11.5	32	11.5	2.01
Y32.6X9.6	32.6	9.60	1.874
Y32.8X3.4	32.8	3.40	0.851
Y33.3X3.6	33.27	3.62	0.914
318	33.4	3.38	0.864
Y34X1.5	34	1.50	0.415
Y34X2	34	2.00	0.545
Y35	35	0.80	0.233
Y35	35	0.90	0.261
Y35	35	1.00	0.289
Y35	35	1.10	0.317
Y35	35	1.20	0.345
Y35	35	1.50	0.428
Y35	35	2.00	0.562
Y35.6X4.7	35.6	4.70	1.241
Y36X1.5	36	1.50	0.441
Y36X2.0	36	2.00	0.579
Y36	36	4.50	1.207
Y36X9.25	36	9.25	2.107
JMG030	36.4	3.20	0.904
Y37X2.5	Y37	2.50	0.734
Y38	38	0.90	0.284
Y38	38	1.00	0.315
Y38	38	1.10	0.346
Y38	38	1.20	0.376
Y38	38	1.50	0.466
Y38	38	2.00	0.615
Y38	38	2.50	0.756
YGC05	38.1	2.40	0.729
UBG04	38.1	2.60	0.786
Y38.1X2.9	38.1	2.90	0.857
Y38.1X3.2	38.1	3.20	0.944
YGC08	38.1	6.00	1.64
Y40	40	2.00	0.647
Y40.6X1.8	40.6	1.80	0.594
Y41	41	1.00	0.341
Y41	41	1.20	0.407
Y41	41	1.40	0.472
Y41X9	41	9.00	2.452
VH-8714	42.16	2.77	0.929

型号	外径A	壁厚t	理重(kg/m)
319	42.16	3.56	1.168
Y42.2X3.6	42.16	3.56	1.168
96026	42.5	10.3	2.814
Y36X3.3	42.55	3.30	1.103
96026A	43	10.5	2.905
Y44.45	44.45	1.65	0.601
Y44.8X1.8	44.8	1.75	0.641
Y45	45	1.00	0.375
Y45	45	1.20	0.447
Y45	45	2.50	0.905
Y46X8.5	46	8.50	2.714
JMG040	47	3.50	1.296
Y47	47	14.5	4.012
Y47.5X1	47.5	1.00	0.396
Y47.6X4.8	47.63	4.77	1.738
Y48.3	48.26	2.77	1.072
10682	48.26	2.77	1.073
SB-3790	48.26	3.68	1.397
YGC03	48.3	2.40	0.938
Y48.3X2.6	48.3	2.60	1.012
Y48.3X3.7	48.26	3.68	1.397
Y48.3X5.1	48.26	5.08	1.868
YGC04	48.3	4.10	1.543
YGC58	48.3	4.00	1.51
UBG02	48.3	4.00	1.51
Y48.3X4	48.3	4.00	1.509
Y48.3X4A	48.3	4.00	1.509
UBG03	48.3	4.47	1.67
Y48.3X4.5	48.3	4.50	1.668
Y48.3X9.9	48.3	9.90	3.237
Y49X1.6	49	1.60	0.64
Y50	50	1.00	0.417
Y50	50	1.20	0.499
Y50	50	1.40	0.579
Y50X1.5	50	1.50	0.619
Y50X2A	50	2.00	0.817
Y50X2.0	50	2.00	0.817
Y50X4	50	4.00	1.567
Y50X11	50	11.0	3.652
Y50X14	50	14.0	4.291

圆管

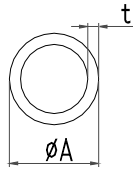

圆管

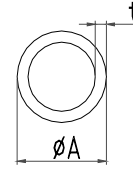

型号	外径A	壁厚t	理重(kg/m)
Y50.8X3.2	50.8	3.20	1.287
Y51	51	0.90	0.384
Y51	51	1.00	0.426
Y51	51	1.20	0.509
Y51	51	1.40	0.591
Y51X1.5	51	1.50	0.632
Y51	51	2.00	0.834
Y53.8X0.8	53.8	0.80	0.361
Y55X11.5	55	11.50	4.259
Y56X9.5	56	9.50	3.76
Y56.5X3.0	56.5	3.00	1.366
Y58.1X0.8	58.1	0.80	0.39
Y60X1.5	60	1.50	0.747
537	60.33	3.92	1.88
Y60.33X5.54	60.33	5.54	2.583
Y60.5X5.0	60.5	5.00	2.363
Y62.5X7	62.5	7.00	3.308
Y63.5X6.8	63.5	6.75	3.261
Y63.5X19.25	63.5	19.25	7.28
TC05	64	2.00	1.056
Y65X2	65	2.00	1.073
Y66.5X25.6	66.5	25.55	8.908
Y68X18.5	68	18.50	7.796
Y70	70	1.00	0.587
Y70X3.9	70	3.94	2.216
Y73X5.16	73.03	5.16	2.98
@70	70.5	6.00	3.295
Y71.5X28	71.5	28.05	10.376
Y73X16.5	73	16.50	7.937
Y74	74	1.50	0.926
@74	74	6.00	3.474
ZYJ04	75	7.50	4.31
Y76.2X2.5	76.2	2.49	1.562
Y76X16.25	76	16.25	8.266
Y77.8X19.9	77.79	19.86	9.8
Y80X12	80	12.00	6.947
Y88.9X3.1	88.9	3.05	2.229
Y88.9X5.49	88.9	5.49	3.9
Y90X13.2	90	13.25	8.658
Y95	95	2.00	1.584

型号	外径A	壁厚t	理重(kg/m)
Y98X15	98	15.00	10.6
ALD13	99.8	1.80	1.502
Y100X15.8	100	15.75	11.297
Y101.6X1.5	101.6	1.50	1.278
Y112X46	112	46.00	25.848
Y114.3X3.1	114.3	3.05	2.889
Y114.3X6.0	114.3	6.02	5.55
Y114.3X8.56	114.3	8.56	7.706
Y117X12	117	12.00	10.727
Y120X1.8	120	1.80	1.811
JDM01	126	1.50	1.59
GM-0014	133.4	11.11	11.565
AP1540	141.3	6.55	7.518
Y141.3X6.6	141.3	6.56	7.525
Y150X3.5	150	3.50	4.365
Y152.4X2.0	152.4	2.00	2.561
Y155	155	1.30	1.701
Y160X7.3	160	7.25	9.428
Y166X17	166	17.00	21.565
V863222	168.3	7.12	9.758
Y180X1.8	180	1.80	2.731
Y180X2.5	180	2.50	3.78
Y186	186	5.00	7.705
YGC53	187	15.00	21.97
Y191.5X20.5	191.5	20.50	29.845
Y200	200	2.30	3.871
Y219X20.62	219.1	20.62	34.9
Y220X12.5	220	12.50	22.08
Y225X5	225	5.00	9.365
Y254X12.7	254	12.70	26.09
Y323.85X25.4	323.9	25.40	64.54

圆棒



型号	直径A	理重(kg/m)
9738	6	0.077
JA06	9.6	0.2

圆棒

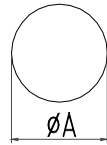

圆棒

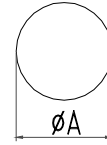

型号	直径A	理重(kg/m)
Y10.2B	10.2	0.221
SWT03	12	0.307
Y12.45B	12.45	0.33
Y12.9B	12.9	0.354
HZY07	13	0.36
SWT04	14	0.417
JA04	14	0.42
Y15.5B	15.5	0.511
HZY14	16	0.545
JA07	19	0.771
Y19.05B	19.05	0.772
Y21B	21	0.939
JA03	22	1.034
Y22.2B	22.22	1.051
Y25.4B	25.4	1.373
JND194	25.4	1.373
Y26B	26	1.439
Y28.6B	28.57	1.738
JA01	29	1.79
JA02	31.75	2.15
Y31.75B	31.75	2.15
Y32B	32	2.18
Y35B	35	2.607
Y38.1B	38.1	3.09
Y38.6B	38.6	3.171
JA05	41	3.591
Y41.3B	41.3	3.63
Y44.45B	44.45	4.21
Y45B	45	4.31
Y50.6B	50.6	5.45
Y50.8B	50.8	5.493
Y54B	53.97	6.2
Y57.15B	57.15	6.952
Y60B	60	7.662
Y60.3B	60.33	7.746
JND104	63.5	8.582
ZYJ06	65	9.1
Y69.85B	69.85	10.39
ZYJ17	70	10.43
ZYJ05	75	12.1
Y76B	76	12.29

型号	直径A	理重(kg/m)
Y76.2B	76.2	12.36
Y80B	80	13.622
Y108B	107.95	24.803

通用转角

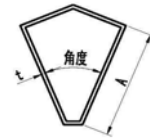

型号	角度	A	t	理重(kg/m)
5010C	45	50	1.2	0.513
5520	30	55	2.5	1.018
7310C	45	76.2	1.2	0.754
7310C	45	76.2	3.0	1.83
7310E	60	76.2	1.2	0.837
88810	45	88	1.0	0.721
88810	45	88	1.2	0.863
88810	45	88	1.4	1.003
9010A	45	101.6	1.0	0.825
9010A	45	101.6	1.2	0.988
9010A	45	101.6	1.3	1.069
9020A	45	101.6	1.2	1.089
9020B	60	100.5	1.2	1.192
88810W-C	65	88	1.1	0.912

90° 转角

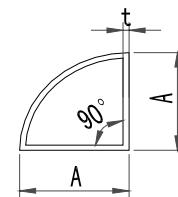

型号	A	t	理重(kg/m)
7310	76	1.2	0.868
7310	76	1.3	0.939
8810C	80	1	0.763
78A10-C	85	1.1	0.892
82810	88	1.2	1
9010	100	1.2	1.144
9010C	90	1	0.859
9010C	90	1.2	1.029